



Waterproof
Beautiful
Elegant
Dependable

SOLARIA

Elegance and strength

Solaria is a simple and powerful retractable waterproof shading system designed to provide a cover solution to existing structures as well as new patio projects.

Solaria's structural components are aluminum powder coated in a classic white color or in any custom color on request to esthetically blend with any specific ambiance.

Hydraulic pistons discreetly inserted within its rails, allow Solaria to maintain its fabric constantly tighten in any selected intermediate position. Due to the high tension exerted to its fabric, Solaria is offered only motorized.

When fully extended, an automatic locking device secure the fabric in place and an even a stronger stretching effect is generated by attempting to roll the fabric back resulting in an easier flow of any possible rain.

Product Features

Waterproof.

Solaria is part of the patio system collection designed by Alutex, and represents a perfect waterproof shading solution for decks and patios either with or without pre existing structures.

Beautiful.

Its design is appealing and its installation simple. The use of a back structural bar allows the positioning of classical awning brackets along its width that can be secured according to the structural elements of the house.

Elegant.

Its fabric rolls in and out from the top while is kept constantly in tension by the loaded pistons within its rails. When locked a t the front, the extra tension generated by the recalling motor, guarantees an easy outflow of rain water.

Dependable.

Solaria is produced with a maximum continuous length of 40' and 23', maximum projection, making Solaria the largest retractable waterproof cover system on the market in its category.

Product Highlights



Solaria's front bar is a moving gutter.



Deploys like a lateral arm



Solaria's fabric is maintained in constant tension



Adjustable anchor plate

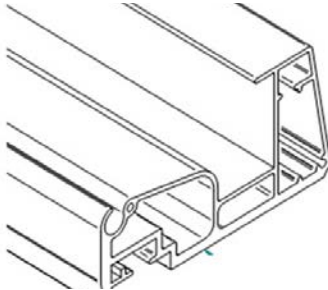

Front bar

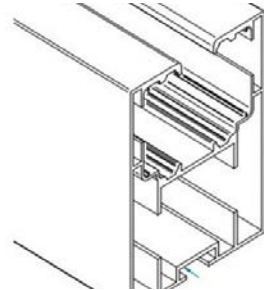

Rail

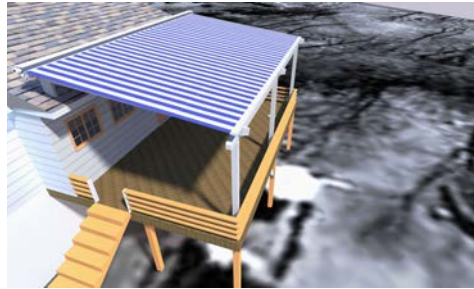
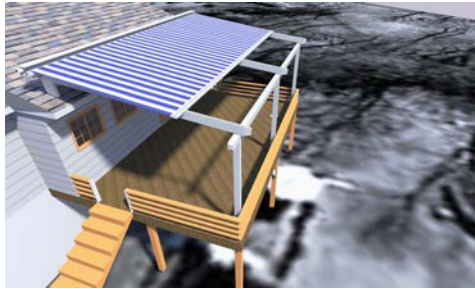
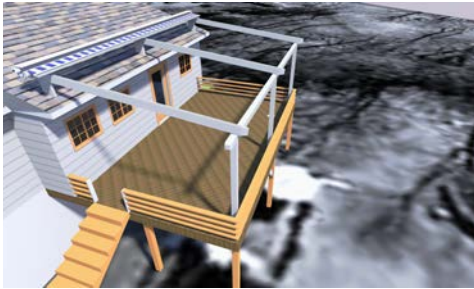

Technical Specifications

Width Range	8' to 40' (1' increment)
Projection Range	8' to 23'
Side dimension w/Hood	9" H
Side dimension	8" H
Hood	Optional
Hood Shape	Round
Opening Control	Motorized only
Installation Option	Wall, Soffit, Roof Mounted
Bracket Size	5 1/2"Hx23 8/8"Wx43 4/4"L

Min. pitch for water flow	10%
Side curtains	Optional
Fabric Option	Heavy Duty Polyester or acrylic
Fabric Options	Over 300 acrylic patterns
Standard Frame Color	White



Custom Frame Color	Any RAL color (on request)
Frame Warranty	5 Years on structural parts

CAUTIONARY AND IMPORTANT OPERATING INFORMATION: Modern pergolas even if waterproof are intended for shade and rain protection only. They are designed to be retracted under snow and ice conditions. They are not designed to withstand snow. During those times, they must be fully retracted to prevent damages not covered by warranty.